

CLAMP MACHINE

MODEL NO CMI69

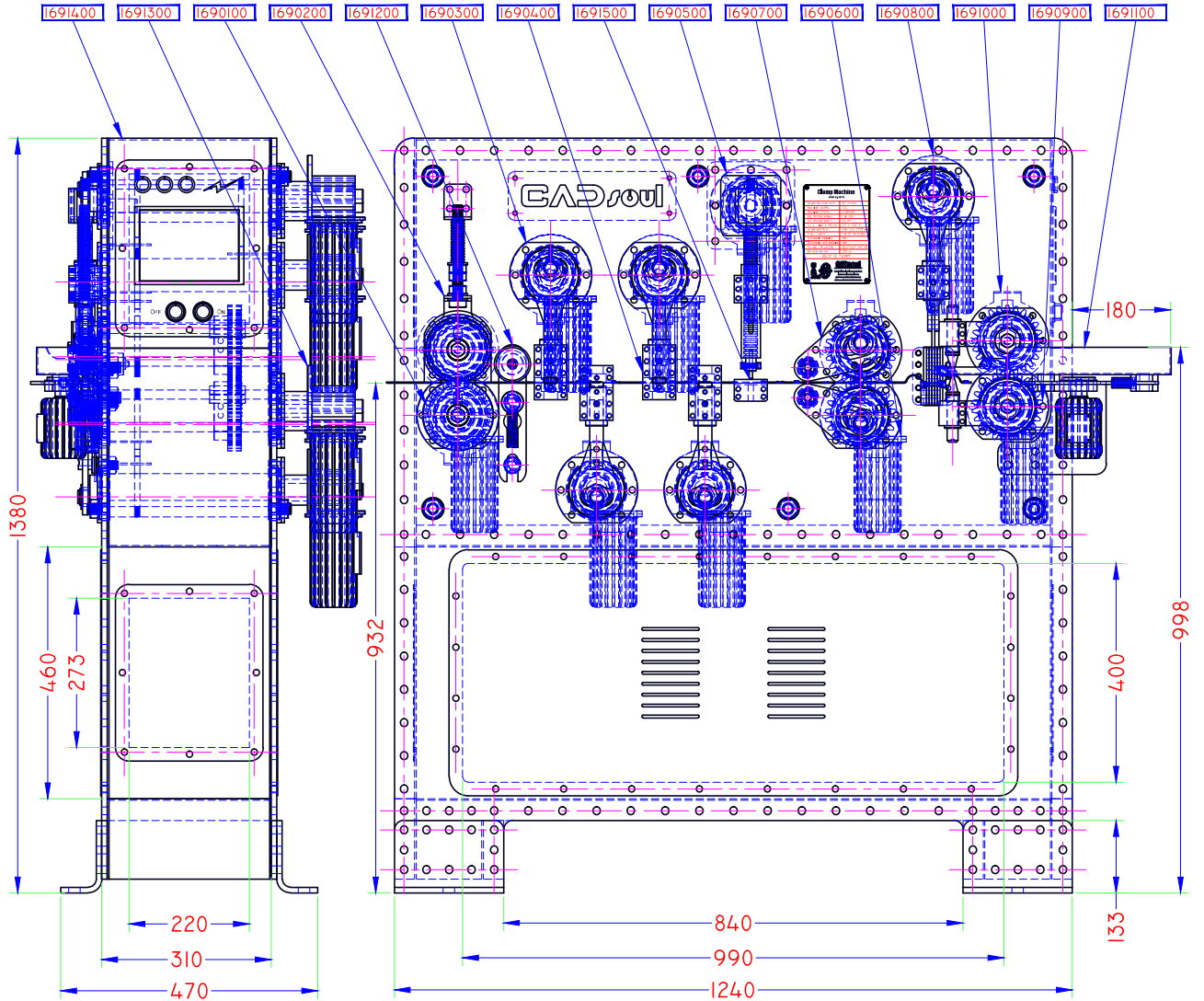
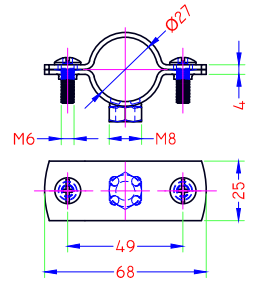

15	1691500	SUB ASSEMBLY OF DIE SET ACCORDING TO REQUIRED CLAMP	0 X 0 X 0	1	ACCESSORIES	0
14	1691400	SUB ASSEMBLY OF MACHINE CASE	89 X 31 X 0	1	ASSEMBLY	0
13	1691300	SUB ASSEMBLY OF MOTOR FIXING	138 X 135 X 150	9	ASSEMBLY	5.2
12	1691200	SUB ASSEMBLY OF ENCODER FIXING	50 X 83 X 182	1	ASSEMBLY	1.427
11	1691100	SUB ASSEMBLY OF NUT FEEDER	432 X 153 X 232	1	ASSEMBLY	3.9
10	1691000	SUB ASSEMBLY OF UPPER WELDING HEAD	383 X 155 X 200	1	ASSEMBLY	14.7
9	1690900	SUB ASSEMBLY OF LOWER WELDER	533 X 129 X 200	1	ASSEMBLY	14.9
8	1690800	SUB ASSEMBLY OF CUTTER	77 X 75 X 399	1	ASSEMBLY	4.047
7	1690700	SUB ASSEMBLY OF UPPER BENDING HEAD	391 X 155 X 197	1	ASSEMBLY	15.8
6	1690600	SUB ASSEMBLY OF LOWER BENDING HEAD	541 X 129 X 197	1	ASSEMBLY	16
5	1690500	SUB ASSEMBLY OF THREADING HEAD	541 X 438 X 160	1	ASSEMBLY	16.7
4	1690400	SUB ASSEMBLY OF ECCENTRIC PRESS	77 X 60 X 245	4	ASSEMBLY	2.982
3	1690300	SUB ASSEMBLY OF ECCENTRIC AXE	150 X 522 X 151	6	ASSEMBLY	11.732
2	1690200	SUB ASSEMBLY OF FEEDER HOLDER	390 X 368 X 150	1	ASSEMBLY	16.4
1	1690100	SUB ASSEMBLY OF FEEDER AXE	540 X 155 X 150	1	ASSEMBLY	16.9
SUM	1690000	MAIN ASSEMBLY OF CLAMP MACHINE	0 X 0 X 0	1	ASSEMBLY	0 KG STEEL

ITEM	PART NO.	TECHNICAL DESCRIPTION	QUANTITY	MATERIAL	UNIT WEIGHT
DRAWING TITLE:		CLIENT NAME:		DESIGNED BY:	
DRAWING NO.:		FINISH		SHEET	
1690000		WHITE		1:104	
		SCALE		DATE	
		DIMS IN MM		01/11/2015	



CADSOUL

WEB SITE : WWW.CADSOUL.COM
E-MAIL: CADSOUL@CADSOUL.COM

DRAWING TITLE:

MAIN ASSEMBLY OF CLAMP MACHINE

DRAWING NO.:

1690000

CLIENT NAME:

DESIGNED BY:

CHECKED BY:

APPROVED BY:

FINISH
WHITE

SHEET
1:104

SCALE
DIMS IN MM

DATE
01/11/2015